

Soft Singing Birdie Rattle



VTech understands that a child's needs and abilities change as they grow and with that in mind we develop our toys to teach and entertain at just the right level...

vtech Baby

Toys that will stimulate their interest in different textures, sounds and colours

I am...

...responding to colours, sounds and textures

...understanding cause and effect

...learning to touch, reach, grasp, sit-up, crawl and toddle

Birth-36 months



Pre-School

Interactive toys to develop their imagination and encourage language development

I want...

...to get ready for school by starting to learn the alphabet and counting

...my learning to be as fun, easy and exciting as can be

...to show my creativity with drawing and music so my whole brain develops

3-6 years



Electronic Learning Computers

Cool, aspirational and inspiring computers for curriculum related learning

I need...

...challenging activities that can keep pace with my growing mind

...intelligent technology that adapts to my level of learning

...National Curriculum based content to support what I'm learning at school

4-10 years



To learn more about this and other VTech® products, visit www.vtechuk.com

INTRODUCTION

Thank you for purchasing the **VTech® Soft Singing Birdie Rattle** learning toy.

Shake, sing and learn with the **VTech® Soft Singing Birdie Rattle**. Shake for fun bird sounds or press the two light-up buttons to learn about the bird and hear fun music, songs and sounds. Removable electronics allow the soft bird to be machine washed.

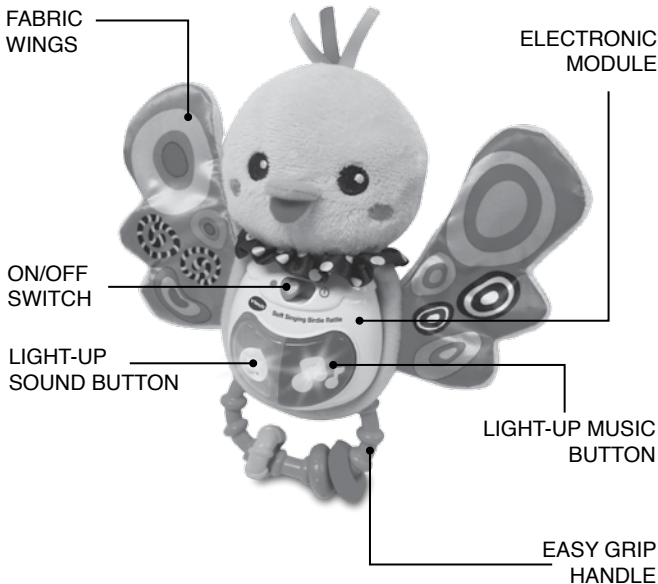

INCLUDED IN THIS PACKAGE

- One VTech® Soft Singing Birdie Rattle learning toy
- One user's manual

WARNING: All packing materials, such as tape, plastic sheets, packaging locks and tags are not part of this toy, and should be discarded for your child's safety.

NOTE: Please keep this instruction manual as it contains important information.

BATTERY INSTALLATION

1. Make sure the unit is turned **OFF**.
2. Locate the battery cover on the back of the electronic module. Use a screwdriver to loosen the screw.
3. Install 1 new AAA (LR03/AM-4) battery following the diagram inside the battery box. (The use of a new alkaline battery is recommended for maximum performance.)
4. Replace the battery cover and tighten the screw to secure.

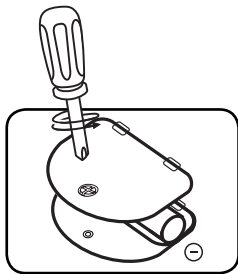

BATTERY NOTICE

- Use new alkaline batteries for maximum performance.
- Use only batteries of the same or equivalent type as recommended.
- Do not mix different types of batteries: alkaline, standard (carbon-zinc) or rechargeable (Ni-Cd, Ni-MH), or new and used batteries.
- Do not use damaged batteries.
- Insert batteries with the correct polarity.

- Do not short-circuit the battery terminals.
- Remove exhausted batteries from the toy.
- Remove batteries during long periods of non-use.
- Do not dispose of batteries in fire.
- Do not charge non-rechargeable batteries.
- Remove rechargeable batteries from the toy before charging (if removable).
- Rechargeable batteries are only to be charged under adult supervision.

Disposal of batteries and product



The crossed-out wheeled bin symbols on products and batteries, or on their respective packaging, indicates they must not be disposed of in domestic waste as they contain substances that can be damaging to the environment and human health.



The chemical symbols Hg, Cd or Pb, where marked, indicate that the battery contains more than the specified value of mercury (Hg), cadmium (Cd) or lead (Pb) set out in Battery Directive (2006/66/EC).

The solid bar indicates that the product was placed on the market after 13th August, 2005.

Help protect the environment by disposing of your product or batteries responsibly.



For more information, please visit:

www.recycle-more.co.uk

www.recyclenow.com

PRODUCT FEATURES

1. ON/OFF SWITCH

To turn the unit **ON**, slide the **ON/OFF SWITCH** to the **ON** () position. To turn the unit **OFF**, slide the **ON/OFF SWITCH** to the **OFF** () position.

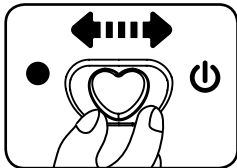

2. ELECTRONIC MODULE

The electronic module is removable so the soft portion of the **VTech® Soft Singing Birdie Rattle** can be washed in a washing machine. **REMOVE** the electronic module before washing the soft rattle. Place the soft rattle in a pillow case and tie the end closed. Machine wash in warm water, on a gentle cycle using mild detergent. Air dry. Do not use bleach.

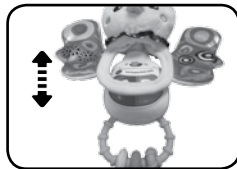

3. AUTOMATIC SHUT-OFF

To preserve battery life, the **VTech® Soft Singing Birdie Rattle** will automatically power-down after approximately 30 seconds without input. The unit can be turned on again by pressing any button. Activating the motion sensor will not turn the unit back on.

ACTIVITIES

1. Slide the **on/off switch** to turn the unit on. You will hear a sound, a fun phrase and a song. The lights will flash with the sound.

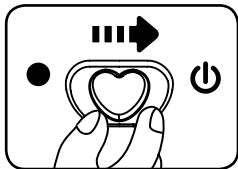

2. Press the **light-up sound button** to hear a variety of phrases and sounds. The lights will flash with the sound.



3. Press the **light-up music button** to hear songs and melodies. The lights will flash with the sound.



4. Activate the **motion sensor** to hear a variety of sounds and melodies. When a melody is playing, shake the rattle to hear the sounds play over the melody. The lights will flash with the sound.



MELODY LIST

1. Alouette
2. Go Tell Aunt Rody
3. Sing a Song of Sixpence
4. Jack & Jill
5. My Bonnie Lies over the Ocean
6. Little Boy Blue
7. Mary, Mary Quite Contrary
8. She'll Be Comin' Round the Mountain
9. Teddy Bears' Picnic
10. Polly Put the Kettle On

SING-ALONG SONG LYRICS

SONG 1

I'm a birdie, a cute fluffy birdie.
Chirping, cheeping, tweeting songs for you.

SONG 2

I like to fly and soar through the sky.
I like to see the world from way up high.

SONG 3

I feel so happy when I am flying,
I fly here, there and everywhere!

CARE & MAINTENANCE

1. Keep the unit clean by wiping it with a slightly damp cloth.
2. The plush birdie is machine washable. Please remove the electronic module from the birdie and follow the care instructions on the tag.
3. Keep the unit out of direct sunlight and away from any direct heat source.
4. Remove the batteries when the unit will not be in use for an extended period of time.

5. Do not drop the unit on hard surfaces and do not expose the unit to moisture or water.

TROUBLESHOOTING

If for some reason the program/activity stops working, please follow these steps:

1. Please turn the unit **OFF**.
2. Interrupt the power supply by removing the batteries.
3. Let the unit stand for a few minutes, then replace the batteries.
4. Turn the unit **ON**. The unit should now be ready to play again.
5. If the product still does not work, replace with an entire set of new batteries.

If the problem persists, please call our Consumer Services Department at 01235 546810 (from UK) or +44 1235 546810 (outside UK) and a service representative will be happy to help you.

IMPORTANT NOTE:

Creating and developing **Infant Learning** products is accompanied by a responsibility that we at **VTech®** take very seriously. We make every effort to ensure the accuracy of the information, which forms the value of our products. However, errors sometimes can occur. It is important for you to know that we stand behind our products and encourage you to call our Consumer Services Department on 01235 546810 (from UK) or +44 1235 546810 (outside UK), with any problems and/or suggestions that you might have. A service representative will be happy to help you.

CLASS 1
LED PRODUCT



PRODUCT WARRANTY



Thank you for choosing this quality product from VTech. We hope it will bring many hours of entertainment, imaginative play and learning.

1. The product detailed above is covered by a one year warranty from the date of purchase, against any defects in materials or workmanship.
2. The product may be returned to the place of purchase. Alternatively the product can be returned to VTech Electronics Europe plc (see address below), with proof of purchase, without proof of purchase no replacement will be provided.
3. VTech Electronics Europe plc will examine the product and if it is found to be defective due to faulty materials or workmanship, will replace the product at their discretion.
4. If the product covered by this warranty is damaged due to misuse, modification or unauthorised repair, or because of faulty batteries, battery discharge or incorrect electrical connections, then this warranty becomes void.
5. This warranty is personal to the original purchaser and is not transferable.
6. Breakages to the LCD screen are not covered by the warranty.
7. Returns to VTech Electronics Europe plc should include a cheque or postal order for £1.50 towards the cost of return postage and packaging.
8. Products returned to VTech Electronics Europe plc, should be addressed as follows and packed carefully to avoid damage in transit (Please do not include batteries or adaptor).
Please include details of the fault together with your name and address.
9. To keep an online record of your warranty, please register your product online at www.vtech.co.uk/warranty

VTech Electronics Europe plc, c/o Tablogix Limited, 200 Milton Park, Abingdon, Oxon OX14 4TA

THIS WARRANTY IS OFFERED AS AN EXTRA BENEFIT AND DOES NOT AFFECT CONSUMERS' STATUTORY RIGHTS.

This warranty is valid for the UK and Eire only. For products purchased outside the UK and Eire, please contact your local distributor or place of purchase.

